

A D O R A

Designed around you.

MEET  
THE NEW  
GENERATION



# ADORA

## MEET THE NEW GENERATION

The new generation Adora, our best-selling caravan just got even better. The most aerodynamic caravan now available, with distinctive Adria silhouette and extra-large in-line panoramic window, wider door and smart storage. Feel inspired and at home in the elegant interior with new kitchen, bathroom, bedroom and contemporary living spaces.

*Everything is new and designed around you.*



472 UP

502 UL

522 UP

542 UL

572 UT

573 PT

613 HT

613 PK

613 UT

673 PK

753 UK



Adria MACH smart control mobile app.



**INSPIRED DESIGN**

Our designers brought inspiration from the award-winning Astella to bring a whole new design to this new generation caravan.

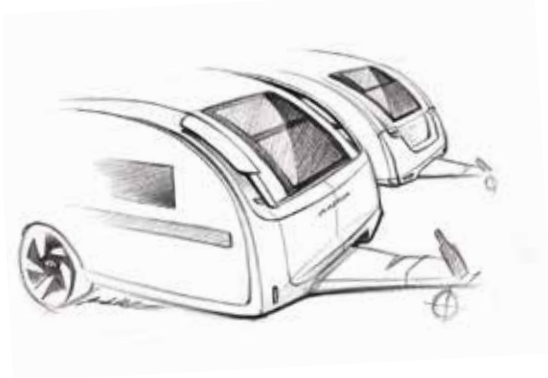

NEW SILHOUETTE



NEW INTEGRATED FEATURES



Exterior features

- 1 NEW EXTERIOR DESIGN**, clean and elegant with new graphics.
- 2 NEW REAR WALL DESIGN**, with new multi-functional full LED lights.
- 3 NEW PANORAMIC WINDOW**, in-line wider design, on most layouts.
- 4 PERFORMANCE CHASSIS FROM AL-KO** with AKS stabiliser coupling. **AL-KO**
- 5 INNOVATIVE WIND DIFFUSERS**, for more efficient towing.
- 6 WIDE ENTRANCE DOOR** and double-glazed 'flat' tinted windows.
- 7 NEW HIGHER VOLUME STORAGE**, tent profile and integrated handles.
- 8 ALLOY WHEELS** and Continental tyres.



**SIGNATURE FEATURES**

Our designers took the best of the Adora's signature features and improved them.



**NEW IN-LINE PANORAMIC WINDOW**

Our new in-line design brings light and the feeling of space for 'atrium-style living'. Includes integrated shading and ventilation features.



**NEW LED LIGHTS**

New design full LED multifunctional rear lights for automotive style and functionality.



**NEW AERODYNAMIC WIND DIFFUSERS**

This innovative feature, aids wind diffusion, look stylish and help towing efficiency.



**ADRIA MACH**

Features Adria MACH smart control mobile application.

**PERFORMANCE CHASSIS**

AL-KO Chassis for secure and stable towing, with AKS stabiliser coupling and optional ATC trailer control system.



**AL-KO**



**NEW EXTERIOR GRAPHICS**

The new Adora has new automotive style graphics, with familiar Adria lines.





**HOME-STYLE FEELING**

The new generation brings a feeling of home with elegant interiors with bigger spaces, new softer, more integrated forms and a special home-style ambiance.



• New lighting system for controllable ambiance.

• Atrium-style living with extra-large panoramic window.

• New sound system with integrated hidden speakers.

• Organized storage with dedicated spaces for personal items.

• Heating by Truma and Alde.



**360° WALKTHROUGH**  
Step inside Adora, take a 360° Walkthrough on [www.adria-mobil.com](http://www.adria-mobil.com)

## Interior features



**I.** All-new home-style interior design for atrium-style living.

**II.** Comfortable bed solutions with Evopore® mattresses.

**III.** Digital controller, sound system, Bluetooth® amplifier & USB ports.

**IV.** Contemporary living spaces with outstanding comfort.

**V.** New kitchen design with great storage and best appliances.

**VI.** New Ergo bathroom design with innovative optional storage solutions.

**VII.** Alde or Truma heating, plus optional electrical floor heating.

**Alde** **Truma**



### CONTEMPORARY LIVING SPACES

The Adora's inspired living spaces means everything is designed around the way you want to live.

#### LIVING ROOM

The large panoramic window means 'atrium-style' living, with natural light, controllable shading and ventilation.

- Living room beneath large panoramic window.
- Dinette with comfortable seating.
- Easy additional bed set up.
- A durable, light weight put away table.
- Head rests for extra comfort.



**KITCHEN**

The new home-style kitchen design is inspired by the best home kitchens.

- Elegant concave cupboards with more volume.
- High loading capacity drawers.
- Multifunctional hanging profile.
- High quality appliances.

**BATHROOM**

Our new Ergo bathroom, features a new fold-away sink, extra space, new lighting and plenty of storage.

- Improved fold-away system.
- Efficient draining and serviceability.
- Storage for personal things.
- Controllable lighting.







## CONTEMPORARY LIVING SPACES

A choice of layouts designed for the way you want to live, including unique layouts for families.



## ADORA 613 PK

Adora 613 PK our new layout for families, for 2 adults and 1-3 kids, all with 2m beds. Brilliant for guests too thanks to the Adria Exclusive Design® additional rear living accommodation, which is also great day rest or play space under the new rear panoramic window, includes 2 TV points.



## BEDROOM

New bedroom designs, with all formats of bed, for a great night's sleep.

- Higher beds.
- Luxury Evopore® mattress.
- Controllable lighting.
- Storage for personal things.



**INSPIRED SOLUTIONS**

Everything has been reviewed and improved, with innovative new solutions for inspired living and maximum permitted weight loading as standard.



**ADRIA MACH**



smart control mobile application is available as an option. MACH controls key functions, monitor utilities, gives access to user manuals and provides navigation data and Mobile Office functions.

**MULTIMEDIA**

Enjoy more connected living, with new digital control panel and a range of multimedia solutions including new high-quality sound system with hidden speakers, Bluetooth® amplifier, TV point and holder, and multiple USB ports.



**STORAGE**

More storage than you'd think possible. Easy access gas storage outside and inside there's large volume concave design cupboards. Large wardrobe design and multi-purpose kitchen storage, including large capacity drawers and utensils track. Bathroom storage for personal items, including innovative optional removable storage solution.



# ADORA LAYOUTS

ADORA

**472 UP**   
 L 5385 (mm) |  
 W 2296 (mm) | 4

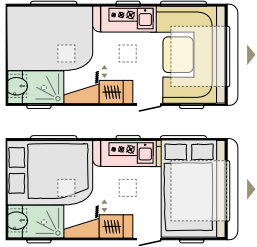

**502 UL**   
 L 5725 (mm) |  
 W 2296 (mm) | 5

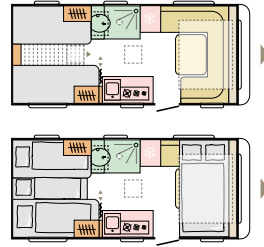

**522 UP**   
 L 5910 (mm) |  
 W 2296 (mm) | 4

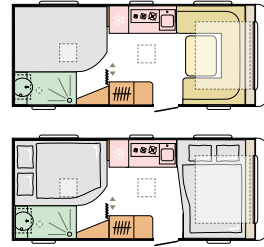

**542 UL**   
 L 6150 (mm) |  
 W 2296 (mm) | 5

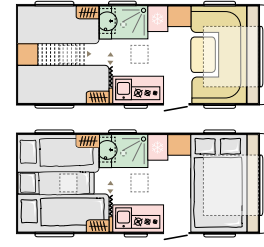

**572 UT**   
 L 6400 (mm) |  
 W 2296 (mm) | 4

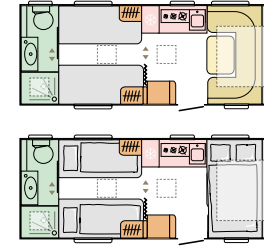

**573 PT**   
 L 6365 (mm) |  
 W 2460 (mm) | 6/7

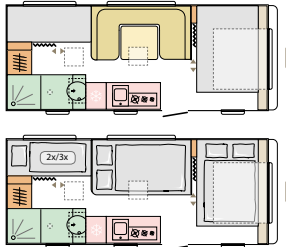

**613 HT**   
 L 6855 (mm) |  
 W 2460 (mm) | 4

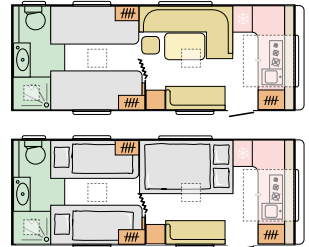

**613 PK**   
 L 6855 (mm) |  
 W 2460 (mm) | 7

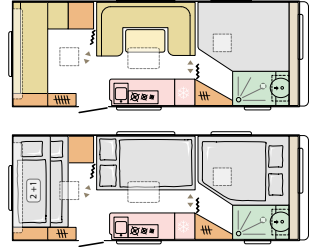

**613 UT**   
 L 6856 (mm) |  
 W 2460 (mm) | 4

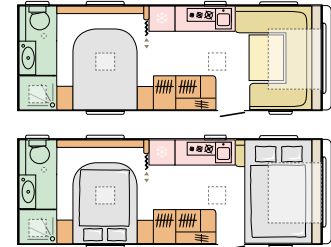

**673 PK**   
 L 7402 (mm) |  
 W 2460 (mm) | 7

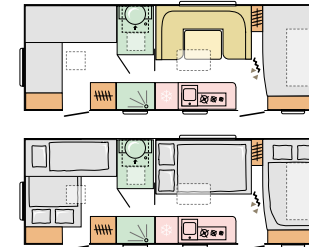

**753 UK**   
 L 8182 (mm) |  
 W 2460 (mm) | 6/7

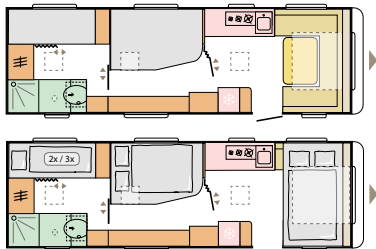

**KEY** features

- New exterior clean design with integrated features.
- GFK body construction, AL-KO chassis, with AKS stabiliser coupling.
- Exclusive new rear wall design with new multifunctional full LED lights.
- Integrated wind diffusers, handles, tent profile, storage and lights.
- Extra-large in-line wider panoramic window on most layouts.
- Wide entrance door and double-glazed 'flat' tinted windows.
- All-new interior design, with contemporary living spaces.
- Comfortable bed solutions with Evopore® mattresses.
- New digital controller, sound system, Bluetooth® amplifier & USB ports.
- All-new living and dining area, with outstanding comfort.
- New kitchen design with great storage and best appliances.
- New Ergo bathroom design with innovative optional storage solutions.
- Alde or Truma heating, plus optional electrical floor heating.
- Couple, family, teenager and child friendly layouts.

**KEY** options

- Adria MACH smart control mobile app.
- AL-KO ATC trailer control system.
- Innovative optional storage solutions.
- Choice of soft furnishings.

**NEW** soft furnishings

There's a wide choice of soft furnishings and cushion colourways available for a much more personal style – yours!

Go to [www.adria-mobil.com](http://www.adria-mobil.com) for more information and vehicle applicability.

**TEXTILES** selection

MISTY ROSE



DARK ALMONDS



STONE ISLAND



MORGAN



DREAM HARMONY

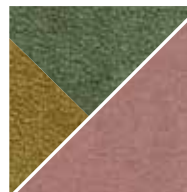

SUMMER VIBES

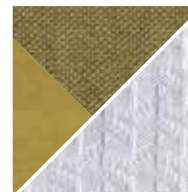

BROWNIES

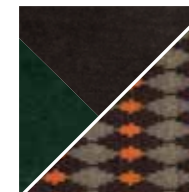

GREY PLANET



MYSTIC GARDEN



WARM BROWNS

